

# Extendable cleaning nozzle

## PopUp Clean

### Series 5P5



#### Features:

- Cleaning nozzle extends automatically depending on pressure
- Flush wall installation possible
- For cleaning agitators and other spray shadow areas
- Compact, robust design



**Function video**  
[www.lechler.com/de-en/medialibrary/videos-general-industry](http://www.lechler.com/de-en/medialibrary/videos-general-industry)  
 Or scan the QR code.

Series 5P5

#### Technical data:



**Maximum operating temperature**  
 95 °C  
 95 °C (ATEX)



**Maximum ambient temperature**  
 150 °C  
 140 °C (ATEX)



**Installation**  
 Operation in every installation position



**Bearing**  
 Slide bearing



**Material**  
 Stainless steel 1.4404 (316L), stainless steel 1.4571 (316Ti), FKM or 2.4602 (Alloy 22), 2.4610 (Alloy 4), FKM



**Weight**  
 340 g



**Surface quality**  
 Ra ≤ 0,8 µm on process side, remaining housing Ra ≤ 1,6 µm



**Surface quality**  
 Ra ≤ 1,6 µm



**Steam suitability**  
 Not suitable



**Recommended filter**  
 Line strainer with mesh size of 0.3 mm/50 mesh



**Recommended operating pressure**  
 2 bar  
 Opening pressure: approx. 0.3 bar, closing pressure: approx. 0.3 bar

#### Installation example



#### Spray height

Sprays upwards in vertical installation position.

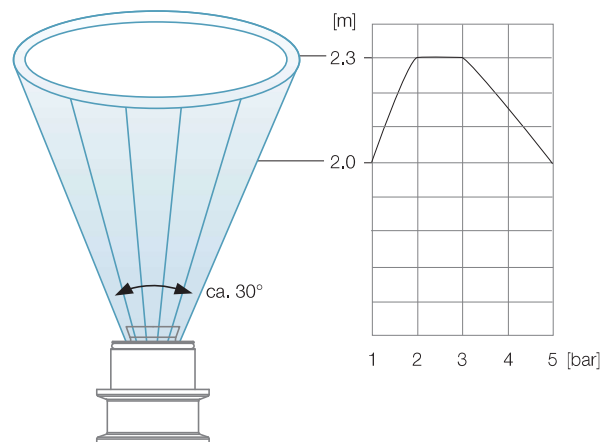

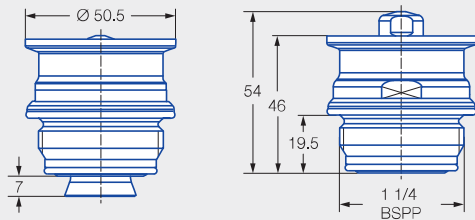

Male threaded connection

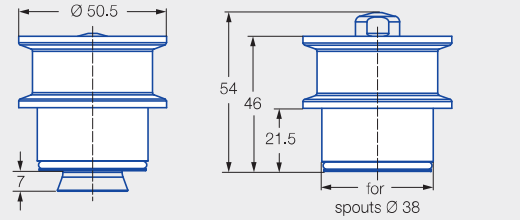

Tri-Clamp connection

Installation situation

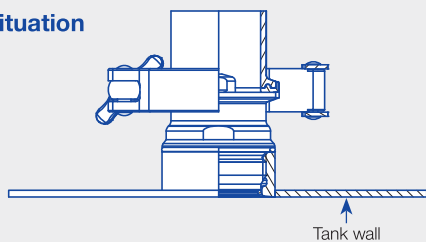

Threaded connection

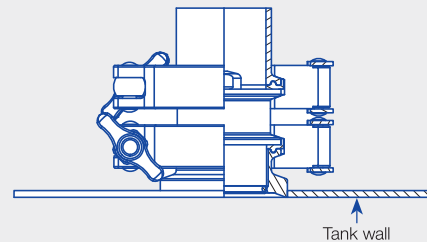

Tri-Clamp connection

Weld-in socket for threaded connection

The thread is hygienically encapsulated with two O-rings (included in the scope of delivery of the PopUp Clean).

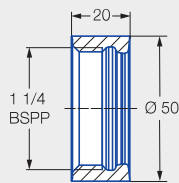

Ordering no.: 050.020.1Y.AQ.00  
Material: Stainless steel 1.4404 (316L)

Weld-in flange for Tri-Clamp connection

A joint clamp in accordance with DIN 32676-A DN50 with a connection diameter of 50.5 mm is required for connection of the nozzle at the weld-in flange. A gasket with a thickness of 2 mm is required if the flange is used in combination with the PopUp Clean.

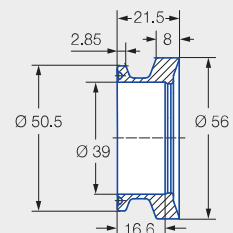

Ordering no.: 050.020.1Y.01.00  
Material: Stainless steel 1.4404 (316L)

Spray angle	Ordering no.					V̇ water [l/min]				V̇ water	
	Type	Material no.		Connection on tank wall		p [bar] (p <sub>max</sub> = 5 bar)					
		1Y	21	1 1/4 BSPP male	Tri-Clamp	1.0	2.0	3.0	5.0	at 2 bar [m³/h]	at 5 bar [m³/h]
30° 	5P5.081	●	●	AP	00	35	50	61	79	3.0	4.7

Information on operation

The PopUp Clean is not suitable for operation with compressed air or another gas. Use above the recommended pressure will have a negative influence on the cleaning result and wear.

Ordering example with FDA and (EC) 1935/2004 conformity.



All materials are suitable for contact with food.



Type + Material + Connection = Ordering no.  
5P5.081 + 1Y + AP = 5P5.081.1Y.AP

Ordering example with ATEX approval. FDA and (EC) 1935/2004 conformity.



Unit group/Category/Zones:  
Ex II 1G Ex h IIB T6...T3 Ga  
Ex II 1D Ex h IIIC T85 °C...T170 °C Da



Type + Material + Connection + ATEX = Ordering no.  
5P5.081 + 1Y + AP + EX = 5P5.081.1Y.AP.EX